

1. Select the desired cable entry slots into the splice tray.
2. Splice the fibers to industry methods and secure the spliced fibers to the splice tray. Install the small foam rubber retainer as shown in Figure 1. The maximum capacity is 12 fusion splices.
3. Assemble the tray to the mounting location with 2 #6 panhead screws at the preferred hole locations. Refer to Figure 1 for six optional locations.
4. For applications with cable entering the bottom openings, cables can be secured to the molded wire tie slots as shown in Figure 1.

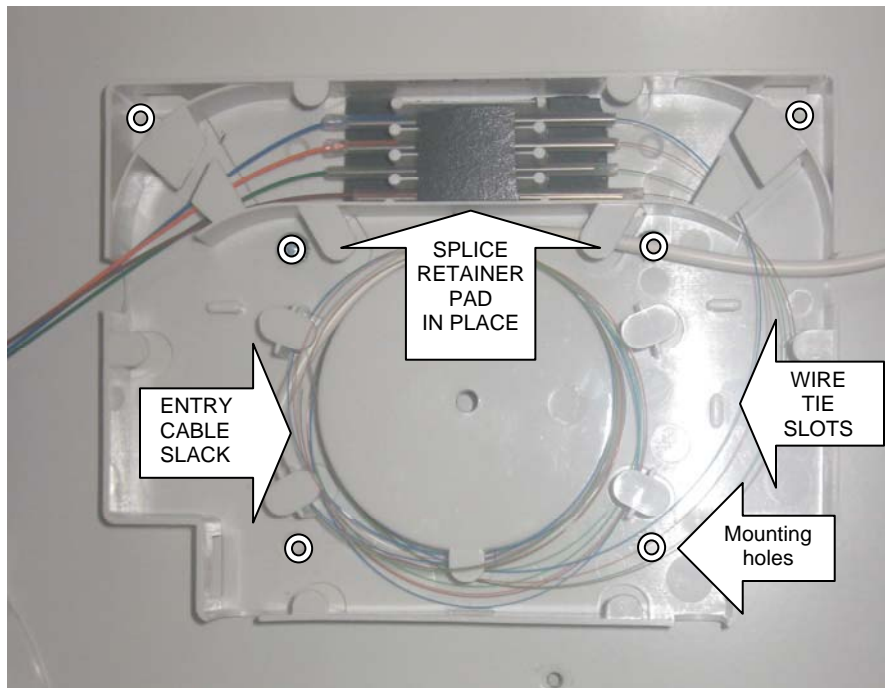

Figure 1

3. Replace the splice tray cover over the tray. Refer to Figure 2.



Figure 2 (Cover installed)